

Reverse Flusher

Code 2166 - Filtration Equipment



Customer Value Proposition:

The Parker Conflow Reverse Flusher has been designed to provide filtration in water feed lines.

The simple, positive action changeover valve provides reverse flushing to clear the main strainer screens without the flowline having to be shut off or the filter element removed.

Due to the design of the main strainer screen the pressure drop across the unit is exceptionally low.

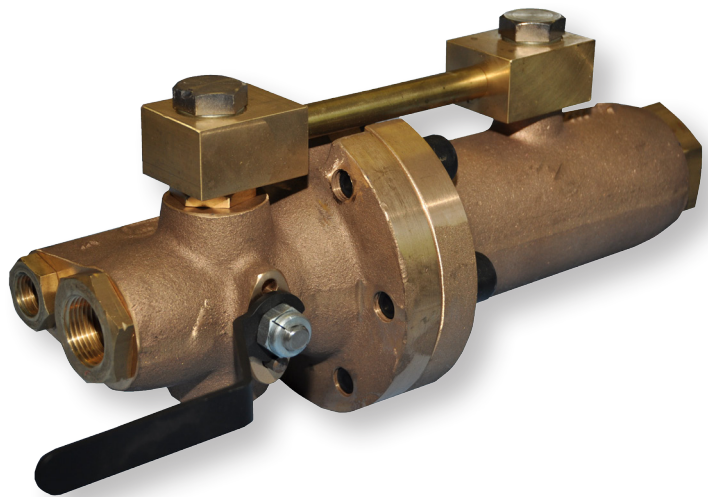

Contact Information:

Parker Hannifin Manufacturing Ltd.
Instrumentation Products Division Europe
President Park, President Way
Sheffield S4 7UR

phone 0044 (0) 114 224 0000
sales@conflow.com

www.parker.com/ipd
www.conflow.com

Product Features:

- 1" & 1 1/4" sizes available
- Maximum working pressure 105 bar
- Reverse flushing without the need for line shut-off or element removal
- Exceptionally low pressure drop
- Simple positive action

Typical Applications:

- Cleaning water being supplied to belt line dust suppression systems
- Cleaning water supplies to longwall faces and continuous miners



ENGINEERING YOUR SUCCESS.

Technical Information

Reverse Flusher - Code 2166

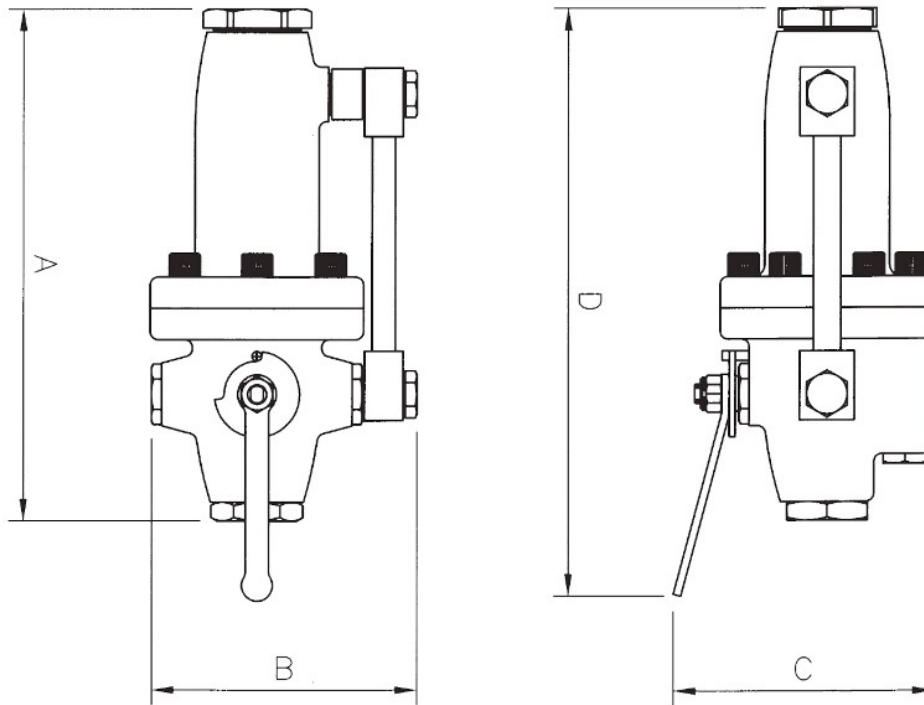

Specifications		
	1" Unit	1 1/4" Unit
A (mm)	356	425
B (mm)	172	218
C (mm)	169	215
D (mm)	390	470
Weight (kg)	17	30

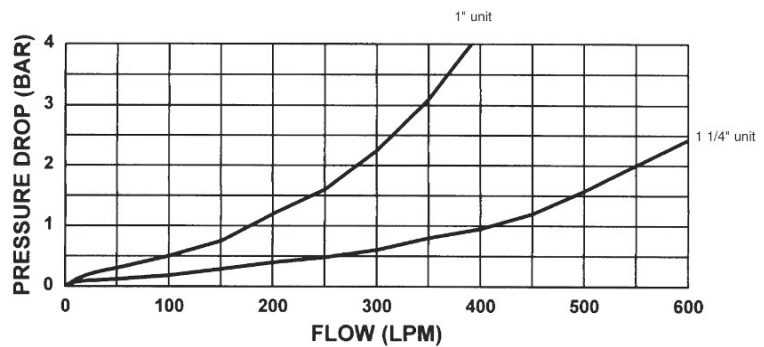

The information on this data sheet is accurate to the best of Parker Conflow's knowledge, however we reserve the right to alter the product specification at any time. For any specific updated detail, please contact us.

© 2016 Parker Hannifin Corporation

Code 2166 June 2016



Parker Hannifin Manufacturing Ltd.
Instrumentation Products Division
Europe

President Park, President Way
 Sheffield S4 7UR
 phone +44 (0) 114 224 0000
www.parker.com/ipd